



UTILITY VAULTS



SHAW
PIPE

www.shawpipe.com

Introduction

UTILITY VAULTS:

SHAW PIPE manufactures precast concrete underground utility vaults and utility structures for a wide variety of uses, including:

- Utility meter chambers
- Telecommunications / electrical duct manholes
- Pull pits
- Air / pressure relief chambers
- Valve chamber
- Large manholes
- Storage / holding tanks
- Pump chambers

SHAW PIPE has three standard sizes available for utility structures:

- 1500 Wide x 2700 Long x 2100 High
- 1800 Wide x 3600 Long x 2000 High
- 3000 Wide x 3600 Long x 2100 High

Intermediate sections can be fabricated to provide additional inside height.

The drawings provided in this section show basic configurations for each unit size. Other configurations, pipe or duct openings, access hatches, or internal walls can be incorporated into the design of each structure. Our design team is available to discuss your project requirements and provide design support, drawings, and details whenever necessary.

1500 X 2700 X 2100 UTILITY VAULT

TYPICAL COVER PLAN

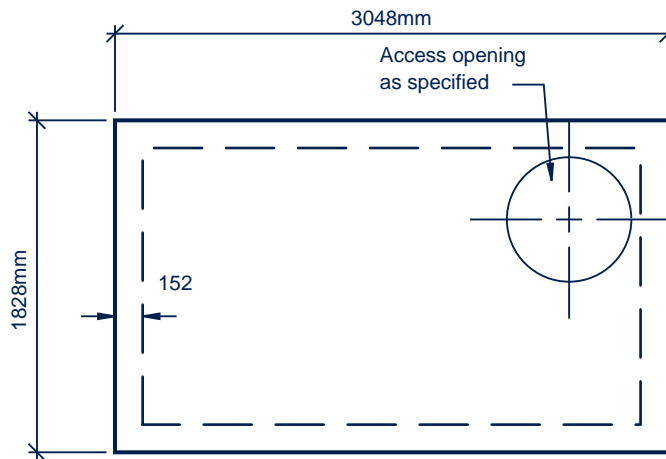

LONGITUDINAL SECTION

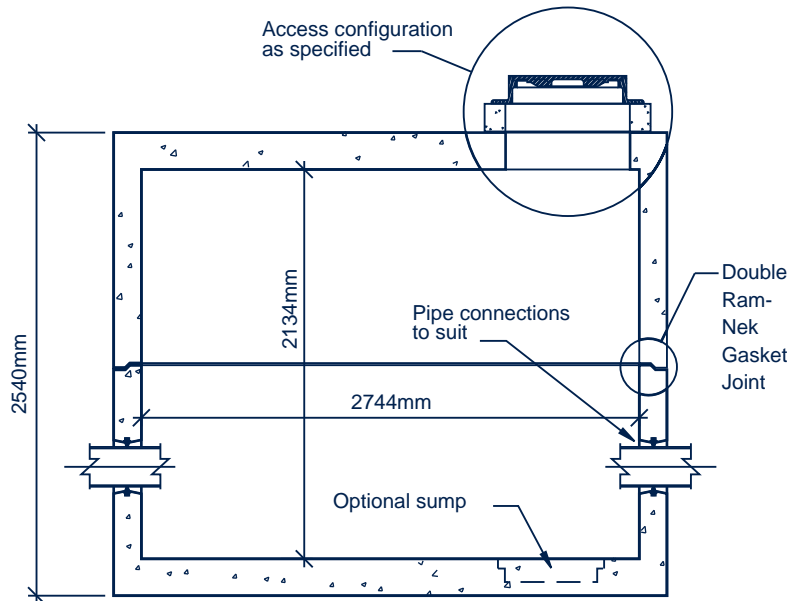

1500 X 2700 X 2100 UTILITY VAULT

TYPICAL BASE PLAN

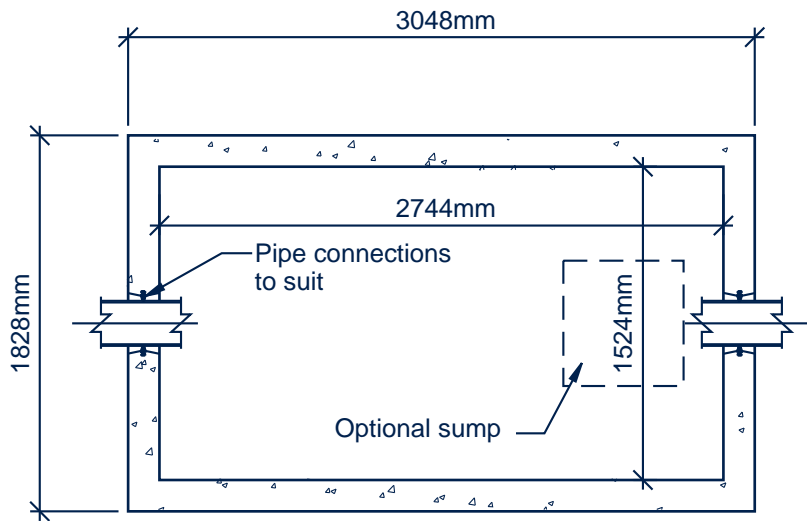

TRANSVERSE SECTION

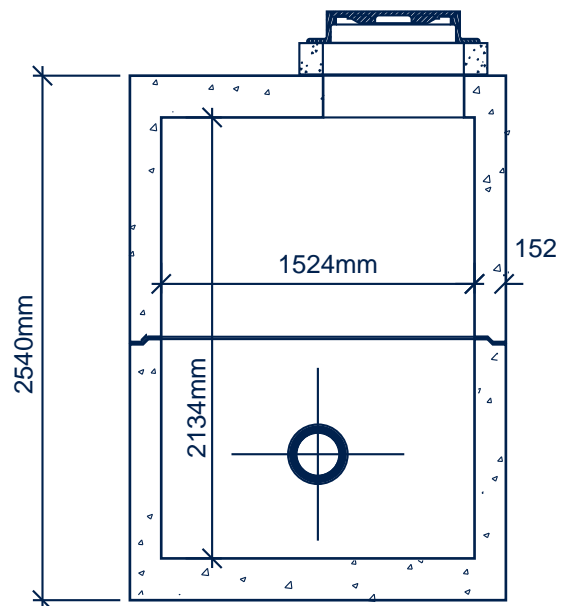

1800 X 3600 X 2000 UTILITY VAULT

TYPICAL COVER PLAN

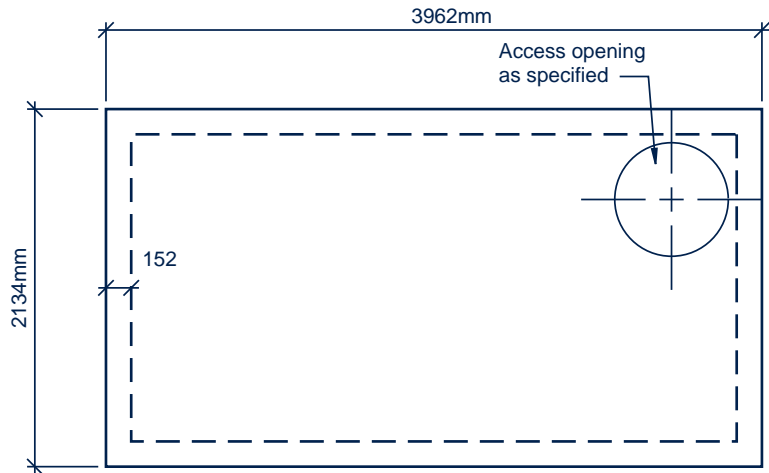

LONGITUDINAL SECTION

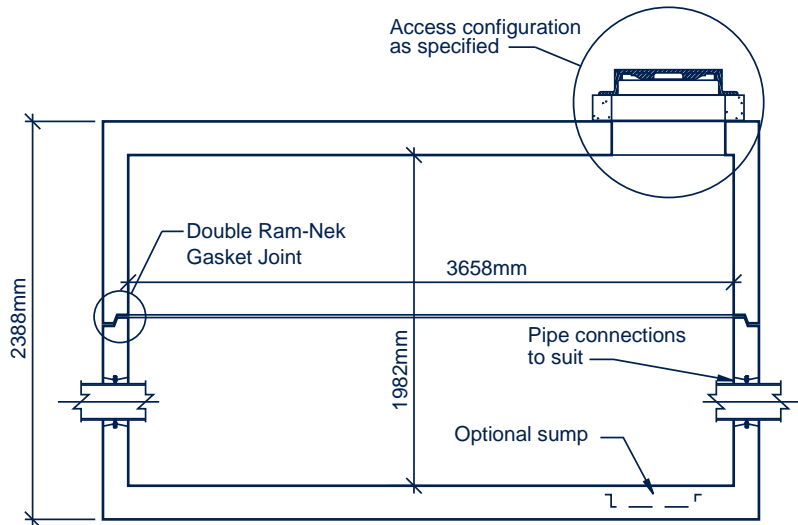

1800 X 3600 X 2000 UTILITY VAULT

TYPICAL BASE PLAN

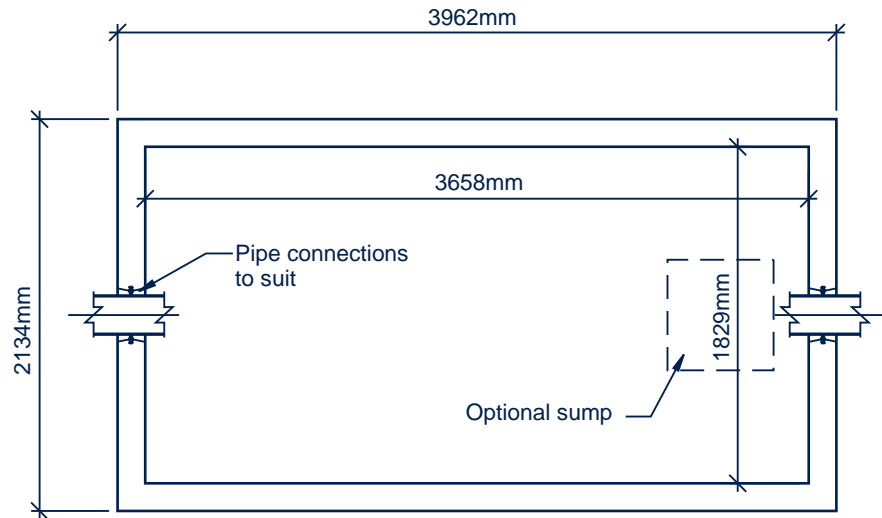

TRANSVERSE SECTION

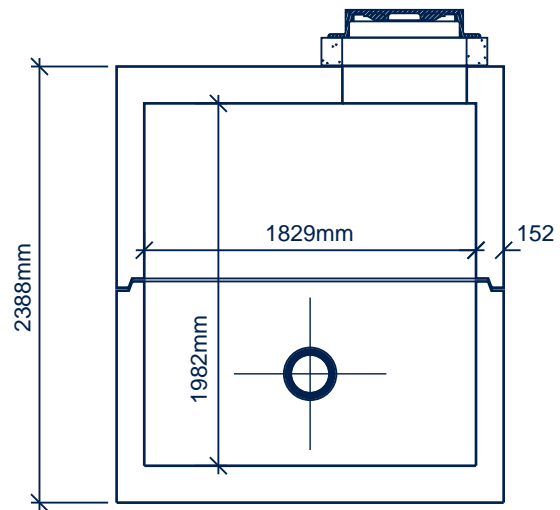

3000 x 3600 x 2100 UTILITY VAULT

TYPICAL COVER PLAN

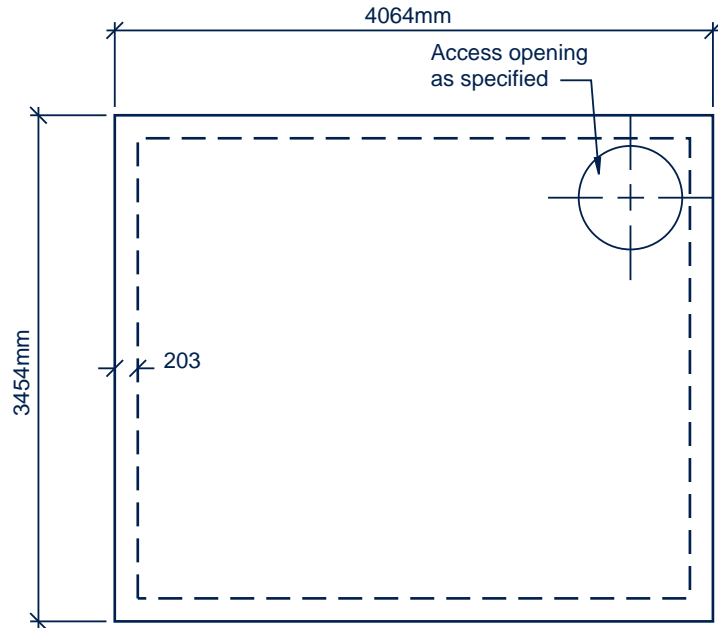

LONGITUDINAL SECTION

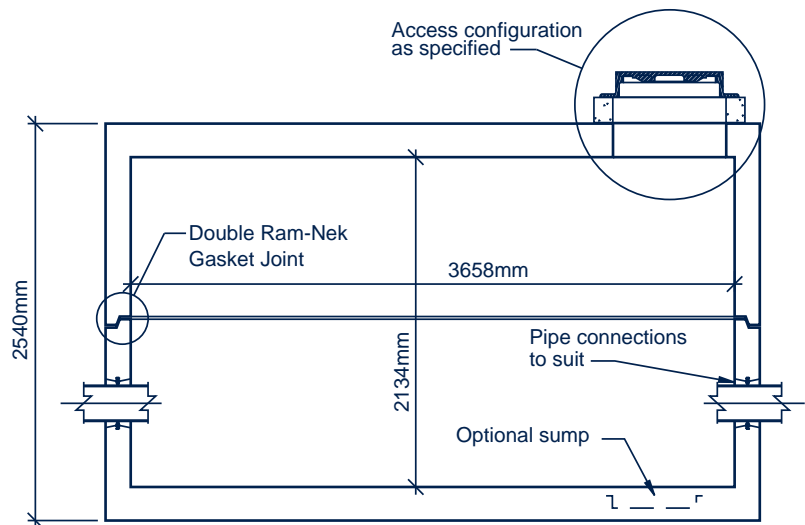

3000 x 3600 x 2100 UTILITY VAULT

TYPICAL BASE PLAN

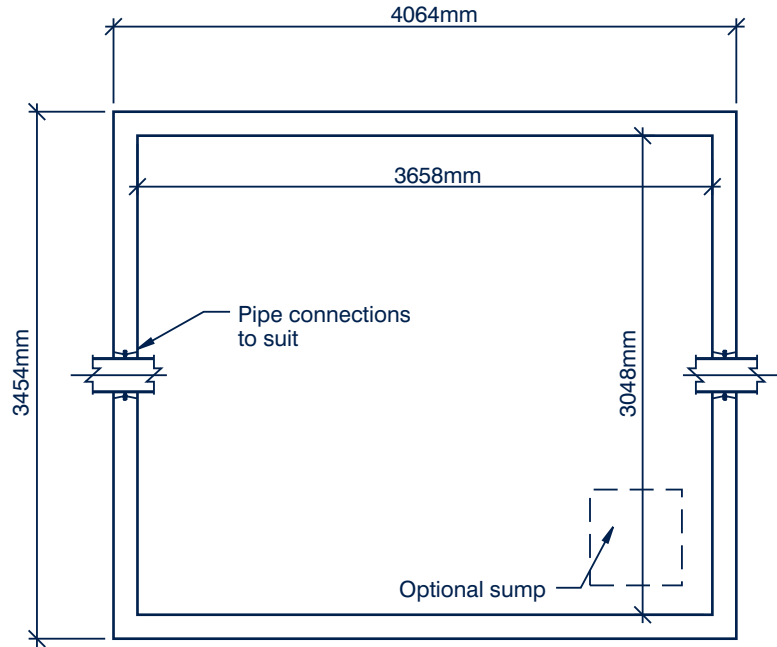

TRANSVERSE SECTION

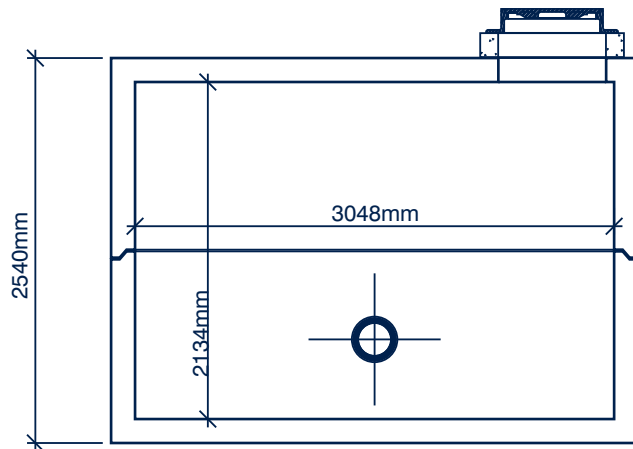

TYPICAL CONFIGURATION FOR UNDERGROUND TELEPHONE AND ELECTRICAL DUCTS

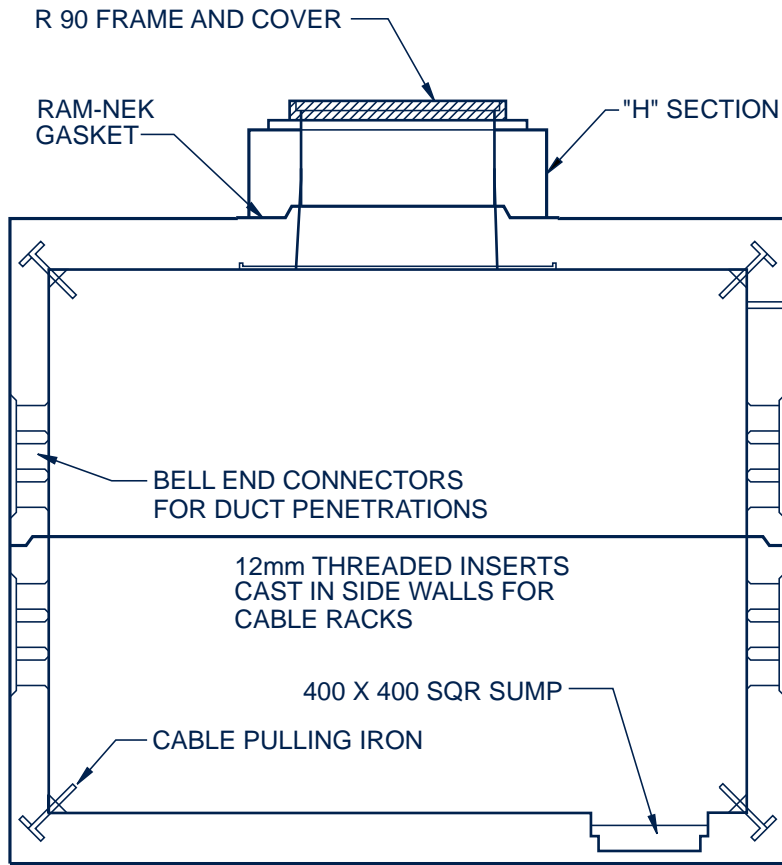

UNDERGROUND TELEPHONE AND ELECTRICAL DUCT CONFIGURATIONS ARE AVAILABLE FOR ALL SIZES OF UTILITY VAULTS

UTILITY VAULTS